

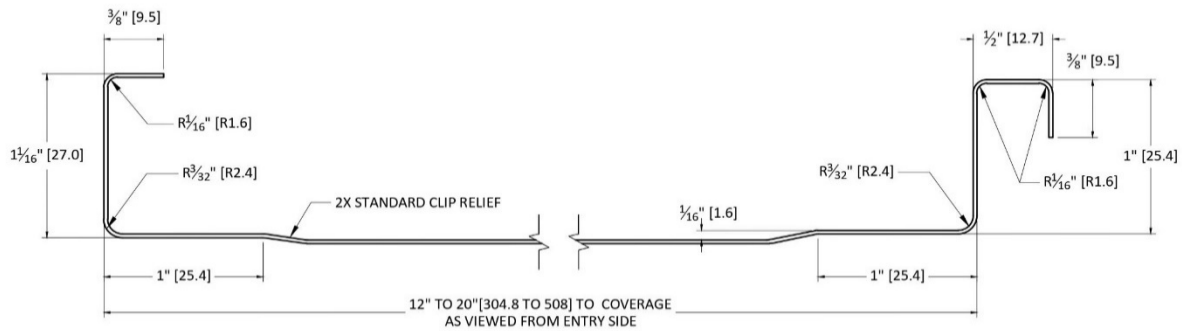

VERSAPAN 100 STANDING SEAM

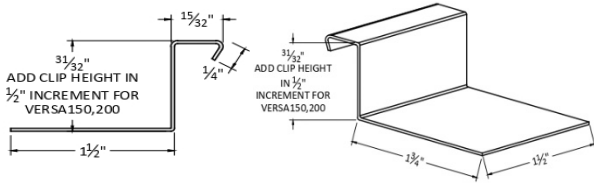

BA CLIP (WOOD FRAME):



BA CLIP (TOP OF INSULATION):

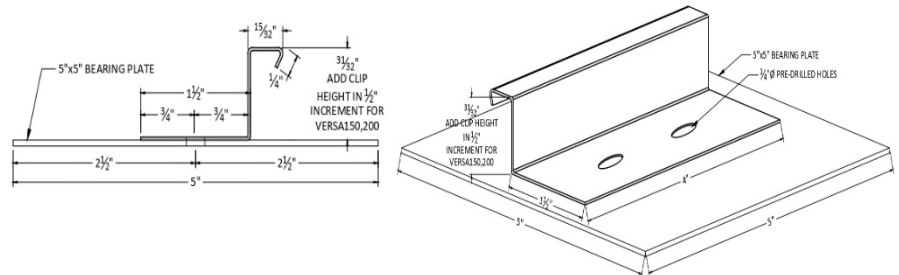

- OPTIONAL PANEL PROFILE:**
- A) FLAT
 - B) BEAD
 - C) V-RIB

- FINISHES AVAILABLE:**
- A) SMP
 - B) PVDF
 - C) PLAIN GALVALUME

Allowable Strength Design Wind load factor – 1.0 18" Wide Panel – 24 ga. (0.024 in.) Allowable Uniform Load (PSF)						
Span	Deflection	Span Length (Feet)				
		3	3.5	4	4.5	5
1	L/180	44	32	24	19	14
	L/240	44	30	20	14	10
	L/360	32	20	13	9	7
2	L/180	46	34	25	19	15
	L/240	46	34	25	19	15
	L/360	45	28	19	13	10
3	L/180	55	40	30	23	18
	L/240	55	40	30	23	18
	L/360	55	38	25	18	13

Note:

- Load data based on ASTM A653, G50 (Fy=50ksi).
- Panel data are subject to change upon Engineer's review, project specific, and site condition.

