

SBS Details: D1.7.6-4 Curbs & Sleepers (Mechanical Opening)

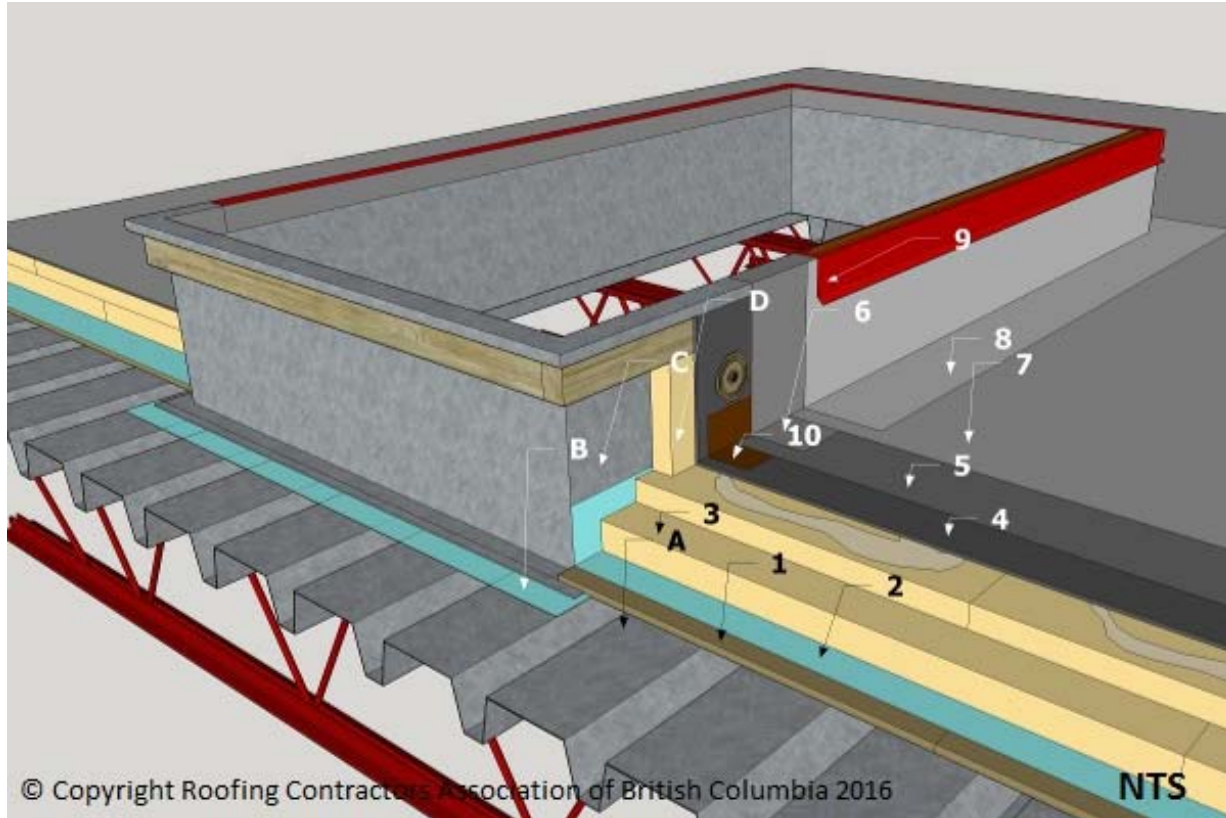

Notice to reader: Drawing for illustration purposes only. Consult the RoofStar Guarantee Standards for more information.

1 WORK INCLUDED

(1) [Gypsum Deck Overlay](#)

Required when insulation is too thin to span flutes of steel decking or when required as thermal barrier by design authority.

(2) [Vapour Retarder](#)

If required by design authority.

(3) [Insulation](#)

Mechanically fastened. See available insulation products in the [Accepted Materials](#) section of this Manual.

(4) [Insulation Overlay Board](#)

As required.

(5) [Base Sheet](#)

Adhered to overlay board using asphalt, cold adhesive, self-adhered, mechanical attachment or torch applied according to manufacturer's specification. Torching directly to wood surfaces is not permitted.

(6) **Base Sheet Flashing**

Adhered according to manufacturer's specifications, using cold adhesive, hot asphalt, self-adhered or torch applied to cover boards, or mechanically attached membrane. Must be tucked under metal flange and mechanically attached to nailing strip.

(7) **Cap Sheet**

Applied according to manufacturer's printed instructions and to *RoofStar Guarantee Standards*.

(8) **Cap Sheet Flashing**

Applied according to manufacturer's printed instructions and to *RoofStar Guarantee Standards*. Must be tucked under metal flange and mechanically attached to the nailing strip.

(9) **Metal Flashing**

Mechanically fasten, standing seam at corners. Full width base flashing optional on flexible membranes. Partial skirt flashing minimum 75 mm (3") required on mechanical curbs that require flashing under metal flange.

2 RELATED WORK BY OTHERS

(A) **Acceptable Deck**

(B) **Air / Vapour Seal**

(C) **Mechanical Curb**

Minimum 200 mm (8") and maximum 300 mm (12") above finished roof surface.

(D) **Rigid Insulation**



ROOFING CONTRACTORS
ASSOCIATION OF
BRITISH COLUMBIA

