

**BA CLIP (WOOD FRAME):**

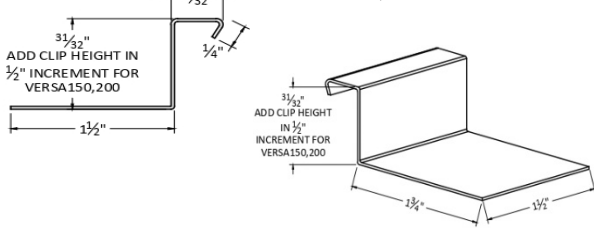

**BA CLIP (TOP OF INSULATION):**

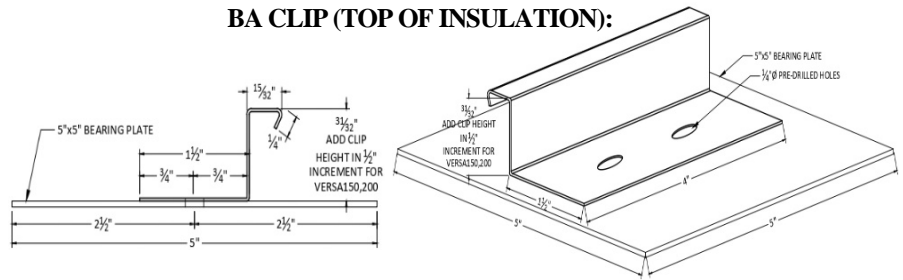

**OPTIONAL PANEL PROFILE:** A) FLAT  
B) BEAD  
C) V-RIB

**FINISHES AVAILABLE:** A) SMP  
B) PVDF  
C) PLAIN GALVALUME

Allowable Strength Design Wind load factor – 1.0 18" Wide panel – 24 ga. (0.024 in.) Allowable Uniform Load (PSF)						
Span	Deflection	Span Length (Feet)				
		3	3.5	4	4.5	5
1	L/180	117	86	65	51	41
	L/240	117	86	65	51	41
	L/360	117	86	65	51	41
2	L/180	117	86	65	51	41
	L/240	117	86	65	51	41
	L/360	117	86	65	51	41
3	L/180	129	96	74	58	47
	L/240	129	96	74	58	47
	L/360	129	96	74	58	47

**Note:**

- Load data based on ASTM A653, G50 (Fy=50ksi).
- Panel data are subject to change upon Engineer's review, project specific, and site condition.

